

General Staff Meeting

14 March 2023

SIMON FISHER



Agenda

1. News from the MD
 - a. Departures and Arrivals
 - b. PhD defenses
 - c. Upcoming events
 - d. Honours and awards
2. News from Data Protection Committee
3. News from TG
4. News from Communication
5. News from Colloquium Committee
6. News from Library Committee
7. News from Research Staff Committee
8. News from the Equal Opportunity Officers
9. News from Ombudsperson
10. News from Diversity, Equity & Inclusion
11. News from Research Facilities Committee
12. News from Phd Representatives
13. News from the Sustainability Working Group

Presentation by Clyde Francks

Genetics of hemispheric specialization in the human brain

Departures and arrivals

Research Staff (RS), PhD students, other staff and long-term guests leaving

Praveen Sewgobind	28.02.23
Elli Tourtouri	31.03.23
Lianne Peters	14.04.23
Olena Ovsianko	31.05.23

New Staff/Research Staff (RS) and PhD students

Tianai Dong	PhD	01.03.23	Multimodal Language
Izabela Jordanoska	RS	01.03.23	Language Development

New Staff/Research Staff (RS) and PhD students (expected)

Hasan Dikyuva	PhD	01.04.23	Multimodal Language
Daniel Sharoh	RS	01.04.23	Neurobiology of Language
Paula Rubio Fernandez	RS	01.06.23	Multimodal Language

New Guests (present)

Emanuela Campisi	RS	01.03.23	Multimodal Language
------------------	----	----------	---------------------

New Guests (expected)

Tomoko Tatsumi	RS	19.03.23	Language Development
----------------	----	----------	----------------------

PhD defense since last staff meeting



- Federica Bartolozzi on 24 January
“Repetita Iuvant? Studies on the role of repetition priming as a supporting mechanism during conversation ”

Upcoming PhD defenses



- Marlou Rasenberg on 17 March
“Mutual understanding from a multimodal and interactional perspective”



- Cas Coopmans on 29 March
“Triangles in the brain: The role of hierarchical structure in language use”



- Lotte Eijk on 14 April
“Linguistic alignment: the syntactic, prosodic, and segmental phonetic levels”



- Laura Giglio on 1 June
“Speaking in the Brain: How the brain produces and understands language”

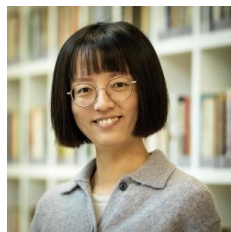

- Jieying He on 7 June
“Coordination of spoken language production and comprehension: How speech production is affected by irrelevant background speech”

Upcoming Events

Visit Max Planck Delegation

20 April 2023 (08:00 – 14:00)

- President-Elect Prof. Patrick Cramer
- Secretary General Dr. Simone Schwanitz



10:30 Address and Q&A for all MPI Staff Members
MPI Auditorium

Upcoming Events



On Saturday 13 May 2023, the Max Planck Institute for Psycholinguistics at the Wundtlaan in Nijmegen will open its doors to the public. Come and marvel at scientific research into the origins of language.

On this day the public can experience interactive demonstrations and informative lectures. There are activities for everyone: children of all ages are welcome!

Upcoming Events – Save the date

Native Listening: A Canteen of Cutlery
June 6-7 2023 MPI Auditorium

Next MPI General Staff Meeting
June 13 2023

MPI Proudly Presents + BBQ
June 27 2023

Honours and awards



Ann-Katrin Ohlerth wins BCN Dissertation Award

For her winning thesis 'Improving preoperative nTMS with a dual-task protocol: the contribution of Action Naming to language mapping'.



The Max Planck Institute for Psycholinguistics in Nijmegen is proud and happy to announce that **Ambra Ferrari** has been awarded a Marie Skłodowska-Curie European Postdoctoral Fellowship .

Data Protection Committee DPC

**Updates staffmeeting
14 March 2023**

Annelies van Wijngaarden



The DPC members



Annelies v. Wijngaarden
DPCo Deputy



Dick Schijven
L&G



Jeannette Peters
Operations



Karin Kastens
Equal Opportunities,
Library



Kevin Lam
IMPRS



Lianne Peters
Research groups &
secretaries



Mante Nieuwland
NBL



Patricia Manko
DP Coordinator



Reiner Dirksmeyer
TG

New mailboxes/ pigeon holes

- New lockable mailboxes!
- For **confidential & personal information** intended for directors and Operations, like
 - Participant declaration forms
 - contracts, agreements,
 - Holiday request forms, letters,
 - e.g. anything only the people concerned should be able to read
- Old pigeon holes can still be used for regular mail



Reminder: Data Protection Training

- Mandatory for all employees
- By one of the committee representatives/appointed person
- Haven't received training yet? Contact us!



Reminder: Index of Data Processing Procedures

- New?
- Postdoc? PhD?
- Project planned? Ready to get started?
- Working with: audio-, video-, imaging- data, self-collected DNA, questionnaires asking sensitive questions (about health, eyesight...), or robots?

Index? = Register of all data processing at MPI, legal requirement

→ **Contact Patricia for a short meeting**



Currently working on....

Experimental key file management

- Central storage for participant key files (= an overview of study participants; usually a studyparticipant number and name or a database ID number)
- Necessary to identify individuals if they want to revoke consent
- Keyfile management: how long to keep?

Deletion procedures for personal data

Guidelines for storage periods of specific types personal data:

- Consent forms
- Declaration forms for reimbursement of participants
- CVs and motivational letters received via email
- And many more



Questions?

privacy@mpi.nl

Data breach?

Contact: data-breach@mpg.de & privacy@mpi.nl

TG

STAFF meeting 14 March 2023



Short report:

- **New tape devices: migration status**
 - **LTO-9** (18 TB per tape, LTO-7: 6 TB)
 - Data migration started in Dec-22
 - user-homes, archive, small files: done; busy with large data sets (done in the background)
- **Renewal of our mass storage systems: BAR request (Jun-23!) ~400 TEUR**
 - Hybrid system: SSD and hard disks
 - Intension to continue using a HSM (Hierarchical Storage Management) system (possible alternative: Qumulo-FS)
 - Online cache: ~800 TB

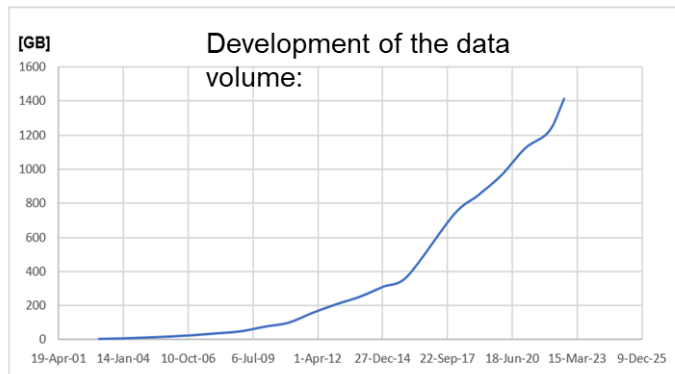

Data volume today: **1.6 PB** (plus 415 TB on HPC cluster),
~209.000.000 files
 Extrapolated, we would expect a data volume of **4-5 PB**
in 5 years.

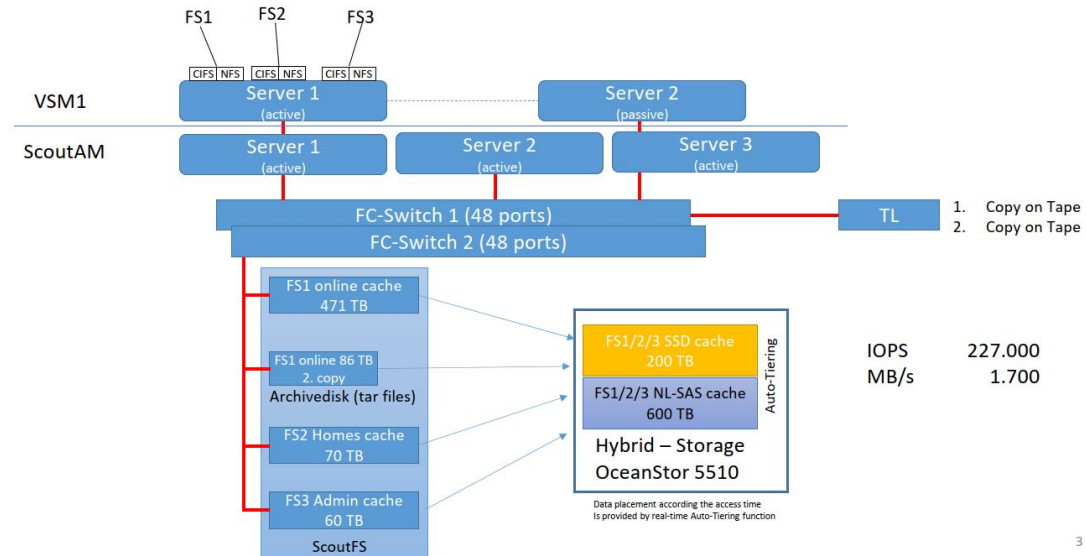

Short report:

- **VMware upgrade: new SSD storage**
 - done!
 - ~100 servers running on 5 VMware servers
- **In progress on experiment setups:**
 - new motion capture lab: Application for large equipment accepted! We can order, now.
 - renew gesture lab: test new cameras
 - in planning: move double EEG setup from room 223 to room 133
- **Phone system:**
 - we are currently in the process of migrating our phone setup to the MPG phone setup.
 - equipment and infrastructure are installed and tested
 - move-over planned in March/April
- **Two-Factor Authentication (2FA/MFA)**
 - GWDG is busy but not ready
 - we will use the 2FA infrastructure that GWDG provides (<https://2fa.gwdg.de>, based on privacyIdea)
(advantage: one setup for using GWDG services and MPI services; less work for us)

Communications

JULIA VON DER FUHR



Communications Team



Marjolein Scherphuis
Julia von der Fuhr
Ludy Cilissen

Communications@mpi.nl



Save
the
date!

M A X
P L A
N C K

OPEN DAG
13 MEI 2023

www.mpi.nl/opendag



M A X
P L A
N C K

External newsletter

- Quarterly corporate newsletter for external audiences
- Feel free to sign up: www.mpi.nl/newsletter



MAX PLANCK INSTITUTE
FOR PSYCHOLINGUISTICS



February 2023

MESSAGES FROM THE MAX PLANCK INSTITUTE FOR PSYCHOLINGUISTICS

This quarterly newsletter informs you about news and events concerning the Max Planck Institute for Psycholinguistics in Nijmegen, The Netherlands. Our institute is entirely devoted to psycholinguistics – the study of how we produce and understand language, and how we acquire these skills as first or second language learners. We hope you enjoy reading about our work.

Please visit our website for a full list of our most recent [publications](#) or take a look at our trilingual science blog [MPI TalkLing!](#)

07 February 2023

Visit our Open Day on 13 May

On Saturday 13 May 2023, the Max Planck Institute for Psycholinguistics at the Wundtlaan in Nijmegen will open its doors to the public. Come and marvel at scientific research into the origins of language.

[Read more](#)



13 December 2022

Hatice Zora receives 'Academic Leadership' award in TOYP Turkey



Social media



@MaxPlanckInstituteforPsycholinguistics



@MPI_NL



@mpi_nl@mstdn.science



Max Planck Institute for Psycholinguistics



@mpi_nl



YouTube Max Planck Institute for Psycholinguistics

MPI TalkLing

- More than 13.000 unique visitors
- The most popular posts on our social media
- Open Day posters

MAX PLANCK Max Planck Institute for Psycholinguistics
4.402 volgers
3 mnd • 🌐

Chameleon 🦎 or /kəmiliən/. Is it easier to process spoken or written language? 📖 Read this interview with [Merel Wolf](#) on her research, interesting findings and new adventures: ...meer weergeven

[Vertaling weergeven](#)



Is it easier to process spoken or written language? An interview with Dr. Merel Wolf

[mpi-talking.mpi.nl](#) • Leestijd: 4 min.

🌐🇳🇱🇵🇹 Cecilia Husta en 64 anderen

2 commentaren • 8 reposts



👍 Interessant

💬 Commentaar

MAX PLANCK Max Planck Institute for Psycholinguistics
4.402 volgers
4 mnd • 🌐

Is it possible to forget a language? 🗨️ Once learned, using language seems effortless. On our blog Cecilia Husta talks about if and how language can be forgotten. ...meer weergeven



Forgetting Language

[mpi-talking.mpi.nl](#) • Leestijd: 4 min.

🌐🇳🇱🇵🇹 Laura Manko en 92 anderen

3 reposts



👍 Interessant

💬 Commentaar

MAX PLANCK

MaxPlanck-Psycholinguistics @MPI_NL · Feb 6

Are you a sleep talker? You are not alone! 66% of people talk when they sleep: words and sentences or maybe just mumbling. But what happens in the brain during sleep talking? Read this blog by [@SaraMazzini4](#) to find out! [mpi-talking.mpi.nl/?p=2064&lang=en](#) @maxplanckpress

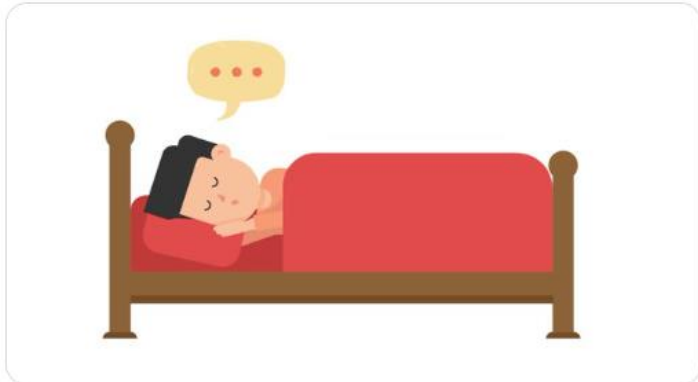

💬 1

🔄 21

❤️ 61

📊 12.7K



Media output

Singing animals: Gibbons found to sing together in a similar rhythm to humans

🕒 13 January · 💬 Comments

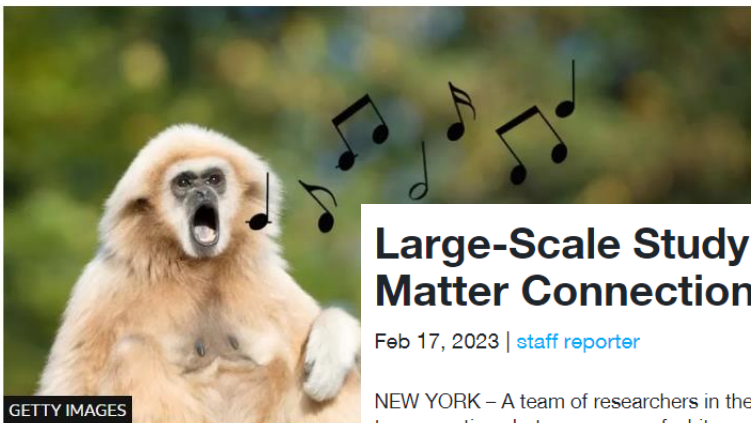

GETTY IMAGES

Gibbon a tune, we bet they'll be able to s

Large-Scale Study Reveals Genetics of White Matter Connections in the Human Brain

Feb 17, 2023 | [staff reporter](#)

NEW YORK – A team of researchers in the Netherlands has discovered genetic factors contributing to connections between areas of white matter in the human brain, including ties between genetic risk of brain disorders and white matter structure.

Drawing on brain imaging and genotyping data from nearly 31,000 participants in the UK Biobank, the researchers, led by Clyde Francks at the Max Planck Institute for Psycholinguistics in Nijmegen, discovered 325 genetic loci associated with white matter structural connectivity, 80 percent of which had not been previously implicated in this process.

Some of the loci were linked to genes strongly expressed in glial cells, suggesting an important role for this cell type in establishing brain structure.

"I think our findings add to a growing literature that glial cells, and not only neurons, are important for forming and maintaining connections in the brain," Francks said in an email.

"Ultimately this might provide a route to targeted therapy for various different brain disorders, for example by stimulating or repressing specific functions of glial cells, while taking into account the particular genetic liability of the individual person," he added.



Wie treurig is, oordeelt beter

Door Nieuwe Feiten



🕒 1 maand geleden 🕒 4 min

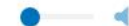

Een beetje treurig zijn heeft ook positieve kanten. Uit onderzoek blijkt dat je dan beter oordeelt. Een van de onderzoekers is **Peter Hagoort**, hoogleraar Cognitieve Neurowetenschap. "We keken vooral hoe we taal op een andere manier begrijpen wanneer we in een gedeprimeerde stemming verkeren versus wanneer we vrolijk door het leven gaan."

Next MPI Colloquium in 2023



The Talking Brain
Language & Communication
Open Theme Meeting
Nijmegen



#genetics #anatomy #neuroimaging #clinical #linguistics #development #evolution



March 21st Kevin Mitchell unfortunately had to cancel

→ Join the BrainHack March 22- 25

<https://www.stephanieforkel.com/theme1meeting>

April 25th

Larissa Samuelson
(University of East Anglia, Norwich, UK)

Hosting Department: LaDD



Sergio-Miguel.Pereira-Soares@mpi.nl

Upcoming colloquia 2023

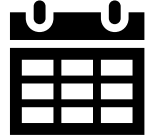

- **May 23rd:** Jordan Zlatev (Lund University)
- **June 19th:** Jonas Obleser (University of Lübeck)

Currently planning the last colloquia of the year so mark your calendars!

- September 26th
- October 10th
- November 21st

Nijmegen Lectures 2024



- Leading scientists
- Speak about language (in the broadest possible sense)



Three-day series of lectures and seminars



Speakers can be invited from anywhere in the world



The screenshot shows the website for the Max Planck Institute for Psycholinguistics. The header includes the logo 'MAX PLANCK FOR PSYCHOLINGUISTICS' and navigation links for 'CONTACT' and 'LOG IN'. A search bar is also present. The main navigation menu includes 'RESEARCH', 'RESEARCH FACILITIES', 'CAREERS & EDUCATION', 'ABOUT US', and 'NEWS & EVENTS'. The page content is titled 'NIJMEGEN LECTURES' and features two event listings:

- NIJMEGEN LECTURES - JULY 5, 6, 7, 2022**
5 JULY 2022 - 7 JULY 2022
The Nijmegen Lectures will take place on July 5-7, 2022.
- NIJMEGEN LECTURES OCTOBER 2018**
15 OCTOBER 2018 10:00 - 16 OCTOBER 2018 19:30
Autonomy, Language, and Consciousness
by Professor Daniel C. Dennett

<https://www.mpi.nl/events/nijmegen-lectures>

Suggestions?

Any suggestions for future **Colloquium** speakers?

Contact us!

Candice Frances: Candice.Frances@mpi.nl / Elli Tourtouri (PoL): Elli.Tourtouri@mpi.nl

Rinus Verdonschot (NBL): Rinus.Verdonschot@mpi.nl

Sergio Soares (LaDD): Sergio-Miguel.Pereira-Soares@mpi.nl

Library Committee Report

Staff meeting 14 March 2023

KARIN KASTENS & LIBRARY COMMITTEE



Library Committee Members

<http://maxintra.mpi.nl/representation/Library%20committee>



Andrea Martin (chair)
Language and
Computation in
Neural Systems



Mubeen Khan
Language and
Genetics
Department



Eleanor
Huizeling
Neurobiology of
Language
Department



Nienke Rulkens-
Dijkstra Language
Development
Department



Library staff
Karin Kastens; head of library
Meggie Uijen; assistant
librarian

email: library@mpi.nl

Research Staff Committee

SEAMUS DONNELLY



Purpose of the Committee

- Forge connections between research staff members across departments (e.g., organizing social events or workshops).
- Provide support for research staff members with issues that are broader than those that can be addressed within their department (e.g., COVID policies, administration issues, training opportunities, or career planning).
- External staff representative represents the scientific staff of our institute at MPG-wide meetings

Research Staff Committee Representatives



Nienke Rulkens-Dijkstra
Research Support Staff Rep.



Seamus Donnelly
Research Staff Rep.
(Chair)



Marieke Woensdregt
Research Staff Rep.



Linda Drijvers
External Staff Rep.

Research Staff Committee Representatives



Nienke Rulkens-Dijkstra
Research Support Staff Rep.



Marieke Woensdregt
Research Staff Rep.
(Chair)

Contact information

RSC@mpi.nl

Equal Opportunities

Staff meeting 14 March 2023

KARIN KASTENS, NATALIA LEVSHINA & MAGGIE WONG



Gender Equality Officers (GEO's)

Who are we?

- Elected for 4 years
- We act for all genders!

What do we do?

- Point of contact for employees for concerns/issues about inequality, discrimination, harassment
- Structural involvement
 - Increase visibility of Gender Equality Work and Support channels
 - Regular meetings with MD, HR, COO, support channels, Diversity committee, etc.



From left to right:

- **Natalia Levshina** (deputy GEO)
- **Karin Kastens** (GEO)
- **Maggie Wong** (deputy GEO)

Information and Support



The training

- provides information on the content and consequences of the policy using practical examples and simulations.
- supports the participants in identifying sexualized discrimination and harassment.
- describes the possibilities and contact points which the Max Planck Society provides for protection against sexualized misconduct.

<https://max.mpg.de>

Search for : Fehlverhalten

The Max Planck Society embraces the ideal of a culture free of discrimination and in which the variety and diversity of its employees are seen as a resource and all are shown the same respect and recognition. No differences of any kind, whether in ethnic origin, family or background, gender, sexual identity or orientation, religion, ideology, disability or age should be permitted to lead to personal or professional disadvantages or affect any individual's chances of acceptance, promotion or qualification.

Survey Diversity, Inclusion and Equality

<https://survey.academiccloud.de/index.php/746972?lang=en>

Points of Contact

<https://maxintra.mpi.nl/representation/EqualOpportunitiesOfficer/conflict-management/conflict-managment>

Contact Equality Officers

Info:

Equal Opportunities on MaxIntra

<http://maxintra.mpi.nl/representation/EqualOpportunitiesOfficer>

Equal Opportunities on mpi.nl

<https://www.mpi.nl/page/equal-opportunities>

Contact:

Email: equality@mpi.nl

Ombudsperson

Staff meeting 14 March 2023

BEATE ST POURCAIN



Ombudsperson

Beate St Pourcain is the Ombudsperson at our institute.

The ombudsperson is an independent, appropriately qualified academic staff member from each MPI, elected to act as an impartial mediator in cases of conflict on matters of good scientific practice.

It is the job of the ombudsperson to be available to all concerned as a confidential advisor for employees from all departments in cases **where there is suspicion of a violation of the principles of good scientific practice.**

The Ombudsperson also helps employees work through work-related problems and conflicts and thus can be contacted to mediate **disputes between employees, employees and Operations and employees and the Directorate.**

Research at the Max Planck institute for Psycholinguistics is guided by the fundamental **principles of research integrity** and fully endorsed by the [Max Planck society](#) .



Beate St Pourcain

Ombudsperson

Senior Investigator
Language and
Genetics
Department

Rules of conduct for good scientific practice

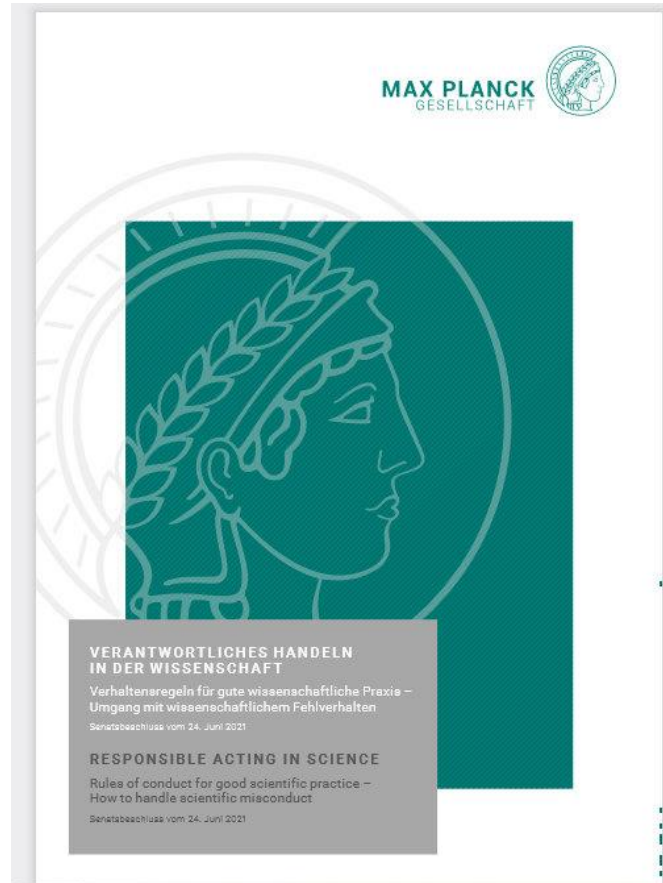

The new version of the

Rules of conduct for good scientific practice
are now available via the MPG homepage

<https://www.mpg.de/199493/regelnWissPraxis.pdf>

<https://maxintra.mpi.nl/representation/ombudsman>

<https://www.mpi.nl/page/ombudsperson>

<https://www.mpg.de/about-us/organisation/ombudspersons>

Contact



MAX-PLANCK-GESELLSCHAFT



[Homepage](#) > [Dr. Beate St. Pourcain](#)



Dr. Beate St. Pourcain
Max Planck Institute for Psycholinguistics
☎ +31 24-3521964
✉ Beate.StPourcain@mpi.nl

Special Function:

- Ombudsperson in the HS (Human Sciences Section)

Diversity and Inclusion Committee

D&I March 2023 meeting summary

CANDICE FRANCES



New Organizational Scheme

- Chair: Candice Frances
- Vice-Chairs:
 - Sandra Bethke (Diversity at the MPI)
 - Barbara Molz (Diversity in our Science)
 - Julia von der Fuhr (Attracting Diversity to MPI)

Current things to look out for

- Working on an inclusive writing guide
 - Join us! Contact: Julia von der Fuhr julia.vonderfuhr@mpi.nl
- Survey (this week's Newsletter)
 - It should take 20-30 min (but can save and get back to it)
 - Raffle prize! TBD
- Buddy system for postdocs and PhDs
 - Email from Candice Frances or Kevin Lam
 - Mentioned in the Sustainability workshop
 - Join us! Contact: Candice Frances Candice.frances@mpi.nl
- RU Solidarity week (April 13th): Inclusive writing workshop + lunch event
- Potluck (associated with Sustainability) details TBD

Want to join? Have ideas to share?



- Contact one of us:
 - Sandra Bethke Sandra.Bethke@mpi.nl
 - Candice Frances Candice.Frances@mpi.nl
 - Barbara Molz Barbara.Molz@mpi.nl
 - Julia von der Fuhr Julia.vonderFuhr@mpi.nl
- Email diversityinclusion@mpi.nl if you have ideas

Research Facilities Committee

RFC March 2023 meeting summary

RUTH CORPS



Recommendations from RFC

- Licenses for Qualtrics have become much more expensive. The following decisions were taken:
 - 5 licenses will be ordered on TG budget (approximately the same as before)
 - 10 licenses will be ordered on LaDD budget
 - LimeSurvey should be used for simpler questionnaires
 - Further licenses can be ordered if necessary
 - Patricia Manko will take over license management

Moving dual EEG lab

- RFC recommended that the dual EEG lab be moved
 - Current room (223) can't be equipped with a sink
 - TG recommends swapping rooms 133 and 223
 - Setting up 132a as a control room; install a sink in 132a or 134
 - Install an additional door between 132a and 134 + a semi-transparent control

Suggested double EEG/Eye-tracking setup:

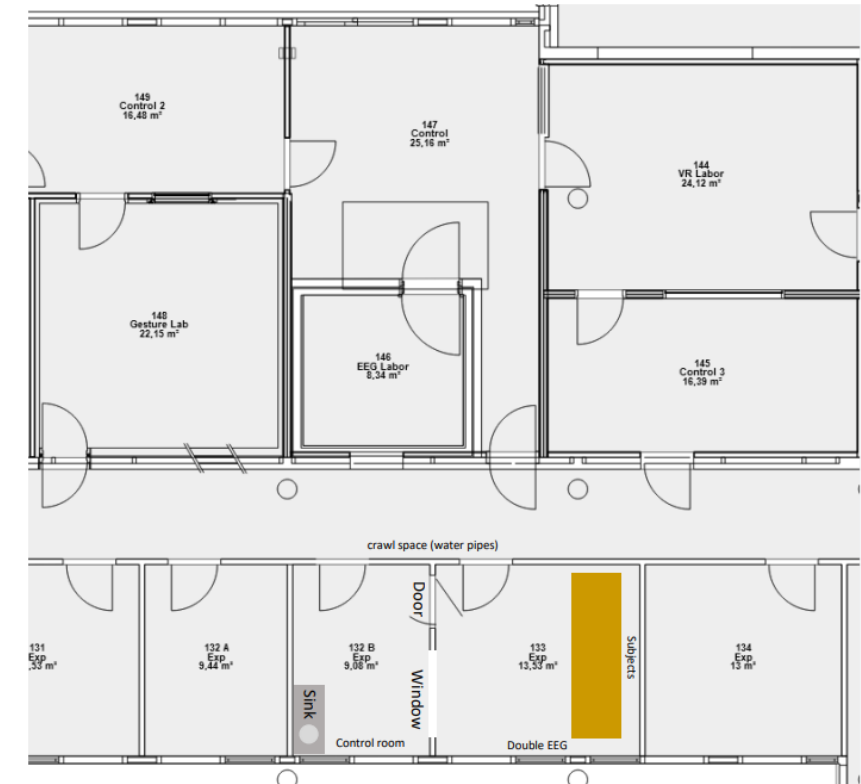

Budget

- The allocated TG budget does not full cover the needs
 - Available 467k, need 484k
 - Some planned projects (e.g., new audio system in 163) could be postponed until next year if necessary

PhD Representatives

RONNY BUJOK, CLARA KUNST, TEUN VAN GILS, LUCÍA DE HOYOS, SARA MAZZINI



Who are we?



Teun van Gils **NBL**



Clara Kunst **LaDD**



Lucía de Hoyos **L&G**



Ronny Bujok **PoL**



Sara Mazzini **NBL**
External PhD Rep

What do we do?

- Official support channel for PhDs
- Need help or support? Don't know where to go?
 - MPI Deans
 - MPI Ombudsperson
 - MPI Equality Officers
 - MPI Human Resources
- Complaints or suggestions?
 - We can help! phd-reps@mpi.nl
- Surveys and social activities

Know where to ask for help

From PhDnet survey 2021:

Which aspects of your work as a doctoral researcher would you like to be improved?

Psychological support: very much (33%), to some extent (33%)

Occupational Health & Safety Service (Arbodienst)

Work-related health problems

Unpleasant working environment

Personal problems

Stress management (e-coaching)

Call to make an appointment:
024-3615400

RU Campus Psychologist

For more info, check the info sheet



Your general practitioner (GP)

Employer and manager assistance program (EMAP)

24/7 anonymous counselling service

Any concerns affecting your well-being and health

available in English and German

Call to make an appointment:
+49 69 25738395

IMPRS & RU well-being courses

PhDnet

- Connection with the other MPI institutes
- Social and academic activities from PhDnet
Check the monthly newsletter →
- You can also get involved!
 - **Join the Secretary Group**
 - Equal Opportunities
 - Events for Career Development
 - Podcasts, Surveys & Website

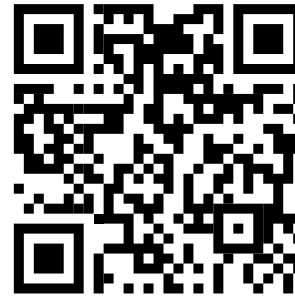

For more info contact us (phd-reps@mpi.nl) or external PhD Rep Sara (Sara.Mazzini@mpi.nl)

[Diversity Excellence Fund and Call for Projects](#)

The call for applications opened on 15 February with the aim of awarding creative projects at the institute level when it comes to promoting diversity and inclusion.

Open to employees at all levels (including PhDs) and the closing date for submission is **6 April 2023**.

Sustainability Working Group



Our Group



sustainability@mpi.nl
Join us!



Update

- (Your) input from the sustainability workshop (Winter 2022) will be shared with the directorate
- Successful potluck dinner – bring your own mug/plate/utensils
- MPI theses will be printed on recycled paper
- Collaborating with D&I and IMPRS:
 - Working on information for new employees
 - Buddy system open to PhD's
 - More social events are coming up!

M A X
P L A
N C K

MAX PLANCK INSTITUTE
FOR PSYCHOLINGUISTICS

WWW.MPI.NL